



**EtherWAN**  
When Connectivity is Crucial



# **EASY** **POE** **BOX**

**NEMA 4/4X CABINET SERIES  
WITH INTEGRATED POE SWITCH**

The All-in-One indoor/outdoor networking solution for surveillance, lighting, and more

# FEATURES AND BENEFITS

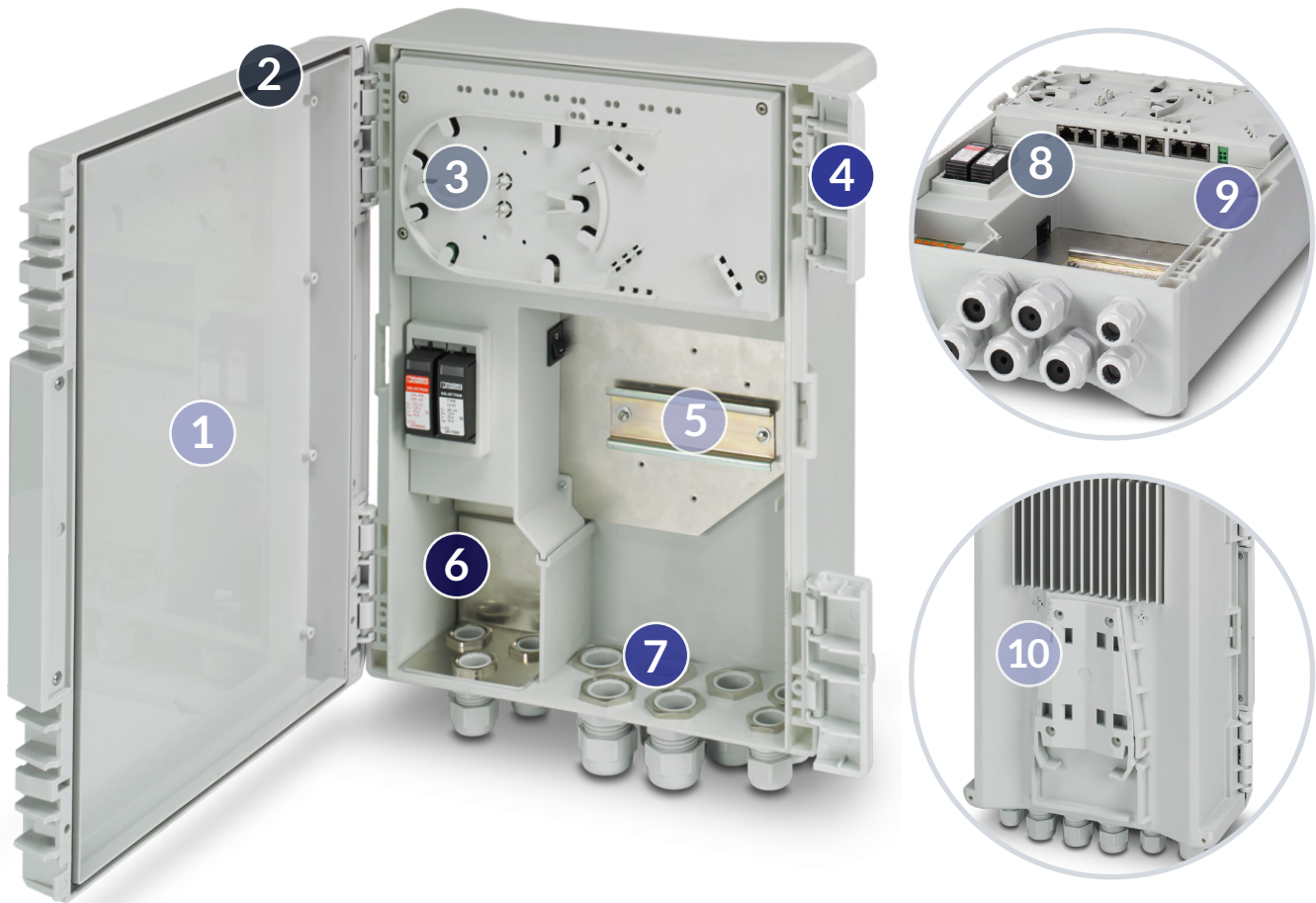

1

## NEMA 4/4X-Rated Enclosure

Vandal (IK10)/Weather/UV resistant and anti-corrosion stainless and polycarbonate material

2

## Hardened-Grade

-40°F to 167°F operating temperature

3

## Fiber Splice Tray

Integrated tray for easy fiber cable splicing and storage

4

## Removable Dual-Hinged Door

Door opens in either direction, allowing for easy installation. It can be completely removed for splicing fiber without interruption

5

## Space for Extras

Built-in DIN-rail and extra room for adding external devices or accessories

6

## Power Supply

Integrated power supply with 100-240VAC input and circuit breakers

7

## Easy Cable Management

10 pre-drilled holes and pre-installed bulkhead connectors for secure and easy cable connections and management

8

## Power over Ethernet Switch

Up to 90W/port, backward compatible with all 15W/30W/60W devices, 165W total budget. 2 SFP or RJ45 uplink ports for sending data to server or distribution point

9

## Auxiliary Power Output

24VDC output for powering auxiliary devices such as call boxes or access controllers

10

## Included Mounting Accessory

Compatible for wall or pole mounting and it can take the heat with external metal heat sink

# MODELS

Model	PoE Protocol	PoE Ports	RJ45 Ports	SFP Ports	Power
EasyPoEBox4S	802.3af/at/bt	4 x 10/100/1000M		2 x 10/100/1000M	100-240VAC
EasyPoEBox4C	802.3af/at/bt	4 x 10/100/1000M	2 x 10/100/1000M		100-240VAC
EasyPoEBox2S	802.3af/at/bt	2 x 10/100/1000M		2 x 10/100/1000M	100-240VAC
EasyPoEBox2C	802.3af/at/bt	2 x 10/100/1000M	2 x 10/100/1000M		100-240VAC

# EASE OF USE

1. No drilling or kitting costs for additional components (all integrated)
2. Managed switch with easy control, monitoring, and configuration
  - Remotely access the configuration interface from anywhere in the network
  - PoE watchdog monitors connected PoE devices and automatically restores non-responsive devices
  - Various port, device, and user controls for security measures

# APPLICATION DIAGRAM

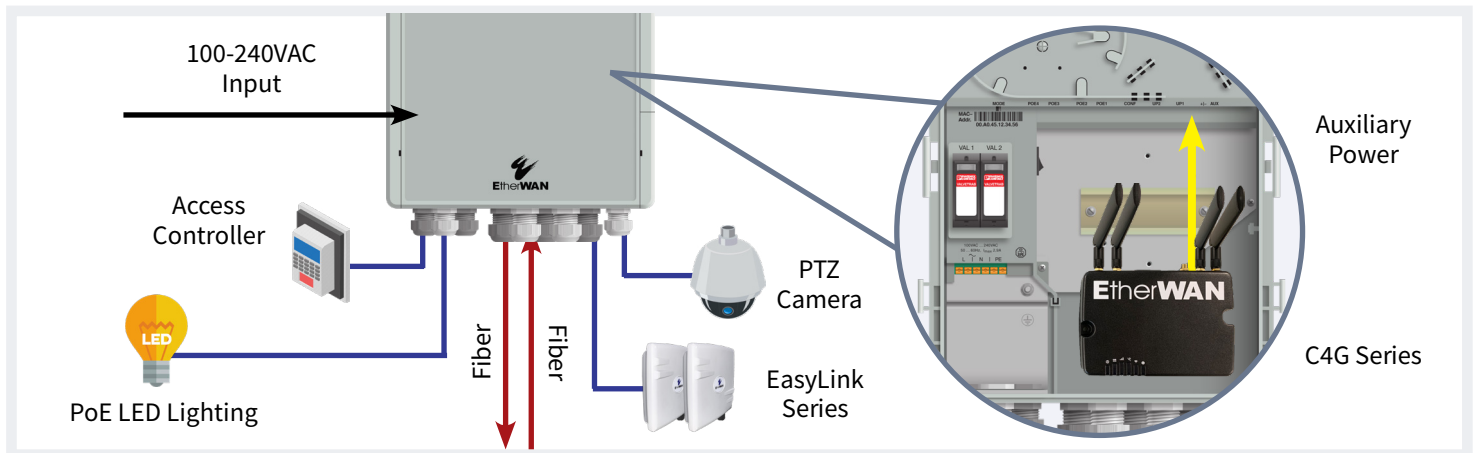

# ACCESSORIES & DEVICES



**EasyLink Series**  
Preconfigured IP67 Wireless Bridge Kit



**RJ45 Patch Panel**  
Easily make ethernet connections without crimping



**C4G Series**  
Dual-SIM 4G cellular router



**Door Lock**  
Stainless Steel locking band for use with padlock

# ABOUT ETHERWAN

EtherWAN is a leader in useful and easy to configure Power over Ethernet solutions. Our PoE products are built to support the long-term health of your network and come in a wide variety of form factors. Designed to operate in a number of environmental conditions, they provide the right networking solution for urban infrastructure communication applications.

Founded in 1996 by NASA engineers, EtherWAN provides Ethernet connectivity solutions for Urban Infrastructure with a core focus on reliability in extreme environments. In-house product design, engineering, and manufacturing are structured to provide quality for crucial connectivity applications.



### Tech Support

US-based tech support provides guidance throughout the project life-cycle. Get support onsite or over the phone.



### Lifetime Warranty

Our hardened-grade products are backed by a lifetime warranty. Register to receive EOL notices and product updates.



### Training for Real-World Applications

Our industry- specific network and product-focused courses are offered online and in-person for easy accessibility.



### Purpose-Built Products

Products are designed, tested and manufactured in-house to ensure the highest quality solutions for specific applications.



### Customer Experience Lab

Train employees and make educated buying decisions with hands-on access to mock traffic intersections, TMC, a variety of IP cameras, and more.



### Cost Savings

Reduce installation time and costs through flexible network solutions, whether installing new cabling or utilizing existing systems.

Contact us for more information on how we can help you design your network.



**EtherWAN**

[www.etherwan.com/us](http://www.etherwan.com/us)



## US Headquarters

2301 E. Winston Road, Anaheim, CA 92806

**TEL:** +1-714-779-3800

**FAX:** +1-714-779-3806

**Email:** [marketing@etherwan.com](mailto:marketing@etherwan.com)

Copyright © 2021 EtherWAN Systems, Inc.  
All rights reserved.